

UNITED STATES DEPARTMENT OF THE INTERIOR  
NATIONAL PARK SERVICE

FOR NPS USE ONLY

RECEIVED

DATE ENTERED 3/21/78

# NATIONAL REGISTER OF HISTORIC PLACES INVENTORY -- NOMINATION FORM

SEE INSTRUCTIONS IN *HOW TO COMPLETE NATIONAL REGISTER FORMS*  
TYPE ALL ENTRIES -- COMPLETE APPLICABLE SECTIONS

**1 NAME**

HISTORIC

South Main Street *Historic District*

AND/OR COMMON

**2 LOCATION**

STREET &amp; NUMBER

South Main Street

CITY, TOWN

Middletown

VICINITY OF

NOT FOR PUBLICATION

CONGRESSIONAL DISTRICT

Thomas Kindness Eighth

STATE

Ohio

CODE

039

COUNTY

Butler

CODE

017

**3 CLASSIFICATION****CATEGORY**☒ DISTRICT☐ BUILDING(S)☐ STRUCTURE☐ SITE☐ OBJECT**OWNERSHIP**☐ PUBLIC☒ PRIVATE☐ BOTH**PUBLIC ACQUISITION**☐ IN PROCESS☐ BEING CONSIDERED**STATUS**☐ OCCUPIED☐ UNOCCUPIED☐ WORK IN PROGRESS**ACCESSIBLE**☒ YES: RESTRICTED☐ YES: UNRESTRICTED☐ NO**PRESENT USE**☐ AGRICULTURE☐ MUSEUM☒ COMMERCIAL☐ PARK☐ EDUCATIONAL☒ PRIVATE RESIDENCE☐ ENTERTAINMENT☒ RELIGIOUS☐ GOVERNMENT☐ SCIENTIFIC☐ INDUSTRIAL☐ TRANSPORTATION☐ MILITARY☐ OTHER**4 OWNER OF PROPERTY**

NAME

Numerous private owners

STREET &amp; NUMBER

CITY, TOWN

VICINITY OF

STATE

**5 LOCATION OF LEGAL DESCRIPTION**

COURTHOUSE,

REGISTRY OF DEEDS, ETC

Butler County Courthouse

STREET &amp; NUMBER

100 High Street

CITY, TOWN

Hamilton

STATE

Ohio

**6 REPRESENTATION IN EXISTING SURVEYS**

TITLE

DATE

☐ FEDERAL ☐ STATE ☐ COUNTY ☐ LOCALDEPOSITORY FOR  
SURVEY RECORDS

CITY, TOWN

STATE



# DESCRIPTION

## CONDITION

☒ EXCELLENT  
☐ GOOD  
☐ FAIR

☐ DETERIORATED  
☐ RUINS  
☐ UNEXPOSED

## CHECK ONE

☐ UNALTERED  
☒ ALTERED

## CHECK ONE

☒ ORIGINAL SITE  
☐ MOVED DATE \_\_\_\_\_

DESCRIBE THE PRESENT AND ORIGINAL (IF KNOWN) PHYSICAL APPEARANCE

The S. Main Street area included in this proposed district presents a display of heterogeneity in architectural styles from primarily the late 1800's. Even with the various styles, a character unique from other areas of the City is established. From the commercial area at the north of the district an easy transition with little distracting intrusions is made into a residential area. All along the way the original elegance of the structures is still present. Under many large trees the various styles of residences maintain a similar setback and massing, that changes neatly from block to block.

A more specific description of individual properties is as follows:

- 1.\* U.S. Hotel (34 South Main Street), 1831, High Victorian, ground floor Italianate, altered. Oldest hotel in Middletown.
2. Rose Furniture/T.V. Howell Building (36 South Main Street), circa 1890, 3 story brick, first use of large glass storefront in City.
3. The two commercial buildings (at 44-46 and 50-52 South Main Street), are of the Victorian style. 44-46 was
4. once owned by an iron foundry which fabricated storefronts and possibly built the building's Italianate facade. It has hood molds and eave brackets and the entire floor facade is of cast iron. 50-52 has a domed bay window with carved wood ornament. It also has a narrow arched window opening that extends up 2-1/2 stories. Both buildings are narrow, emphasizing the verticality of the style. Built in 1890's.
5. The Pickwick Building (56 South Main Street), built in 1836, in the Federal architectural style. Its second story windows have shutters with the exception of the central window which is wood framed and has a wrought iron balcony rail. The entrance features two doric columns with brackets above and an oval stained glass window above the door between the brackets. (photo #2)
6. The Middletown Area Mental Health Center (64 South Main Street), built in 1864, features a palladian motif window, wrought iron railings, side lights and transom around the door, and two brick chimneys. Much of the original interior woodwork remains intact.
7. The George Barnitz Residence (68 South Main Street), was built in 1870, in the High Victorian style, featuring paired eave brackets and round-arched windows with cornice-like hood molds.

\*typed numbers match numbers on key map for both sections 7 & 8.



UNITED STATES DEPARTMENT OF THE INTERIOR  
NATIONAL PARK SERVICE

NATIONAL REGISTER OF HISTORIC PLACES  
INVENTORY -- NOMINATION FORM

FOR NPS USE ONLY

RECEIVED

DATE ENTERED

South Main St., Middletown

CONTINUATION SHEET

ITEM NUMBER 7

PAGE 2

8. Office Outfitters Warehouse (910 First Avenue) intrusion. (photo #4)
9. Kings Kitchen (100 South Main Street), contemporary intrusion. (photo #5)
10. Dr. John L. Bauer (112 South Main Street), Greek Revival large ionic wood columns at front portico, leaded glass door on front porch. (photo #6)
11. American Legion Post (116 South Main Street), original structure altered beyond recognition, possible intrusion.
12. Chapple Leasing Company (124-126 South Main Street), several large brick chimneys, double house diamond shaped shingles.
13. Sohio Station (140 South Main Street), intrusion. (photo #7)
14. 909 Second Avenue, non-descript.
15. The Sorg Mansion (206 South Main Street), was built by industrialist Paul J. Sorg, in 1887. The architects of this Romanesque structure of imported red limestone were Pretzinger and Musselman of Dayton, Ohio. There is a 3-arched entrance and porch which extends around the north turret to a smaller single arched porch. Both porches feature balustrades at the second story level of carved limestone and both have clay tile floors. The turrets, part of a 1902 addition, feature curved glass windows with smaller stained, leaded glass windows above them. Two narrow gables topped with pinnacles extend past the roof line of the Gothic spires of each turret. The spires and all points of the roof are accented by copper pinnacles. The roof itself is of slate. On the walls, at the roof line, there are gargoyles which shed water from the building. The grounds include a carriage house of similar construction and are surrounded by a limestone wall topped with wrought iron fence. (photo #8)
16. Riggs Funeral Home, Inc. (210 South Main Street), altered 1860's, much altered original house from Victorian Italianate style, numerous additions at rear.



UNITED STATES DEPARTMENT OF THE INTERIOR  
NATIONAL PARK SERVICE

NATIONAL REGISTER OF HISTORIC PLACES  
INVENTORY -- NOMINATION FORM

FOR NPS USE ONLY

RECEIVED

DATE ENTERED

SOUTH MAIN ST., MIDDLETOWN

CONTINUATION SHEET

ITEM NUMBER 7

PAGE 3

17. The Theodore Marston House (214-216 South Main Street), was built in the 1870's. It is South Main's best example of High Victorian Italianate style with its stilted segmental arched windows with hood molds and large paired eave brackets of cast iron. The facade is symmetrically massed by window openings, porch opening, and entrance. The entrance is defined by an arched pediment on an architrave supported by doric columns. The windows on the second story north and south bays have wrought iron railings and there is a large window above the entrance. (photo #9)
18. The Calvin Verity Residence (218 South Main Street), 1875, Victorian Italianate.
19. The Daniel McCalley House (228 South Main Street), built before 1866, now features Victorian Italianate detail. Many additions were made in the 1860's and 1870's. (photo #10)
20. George M. Verity home site (230 South Main Street), original house demolished, site is now park with bronze memorial in memory of Verity, founder of Armco Steel Corporation. (photo #11)
21. John B. Tytus, Jr. mansion (300 South Main Street), presently listed as National Historical Landmark. Jacobethan revival structure built in 1868. (photo #13)
22. The Oglesby House (306 South Main Street), 1873, High Victorian Italianate.
23. The C. B. Johnson House (308 South Main Street), 1875, High Victorian Italianate. It features arched windows with hood molds, paired eave brackets and classical entrance. (photo #14)
24. The Jacoby House (314 South Main Street), built in 1887 is of Queen Anne style in brick with wood porch details. It features a Palladian motif window, as well as several arched windows. (photo #15)
25. 320 South Main Street, Queen Anne motif, 1899 altered to multi-family, front gable with Greek sculptured pediment, Greek Doric columns, turret roof front veranda.

photo  
#12



UNITED STATES DEPARTMENT OF THE INTERIOR  
NATIONAL PARK SERVICE

FOR NPS USE ONLY

RECEIVED

DATE ENTERED

NATIONAL REGISTER OF HISTORIC PLACES  
INVENTORY -- NOMINATION FORM

SOUTH MAIN ST., MIDDLETOWN

CONTINUATION SHEET

ITEM NUMBER 7

PAGE 4

26. The Iseminger House (400 South Main Street), was built in 1927, for Mr. & Mrs. Joe Iseminger by Pretzinger and Musselman, architects, of Dayton, Ohio. It is a Spanish Colonial style house with a red clay tile roof which features an eyebrow window. Its stone arch and column entranceway is flanked by two covered verandas. The door is of wrought iron and glass. Much of the interior, including a marble staircase, Italian Marble and Rookwood pottery fireplaces, and oak and mahogany doors and woodwork, remains in its original condition. (photo #16)
27. The Arthur Lefferson Home (404 South Main Street), was built in 1827. It is a Colonial style farmhouse. The oldest house on Main Street, it is the second oldest house in Middletown.
28. The R. C. Phillips House (502 South Main Street) built in 1890's, the house was remodeled to its present appearance by Rufus C. Phillips and is South Main's best example of Jacobethian Revival architecture. Its two three story brick gables are trimmed in stones along with the first story. The doorway is a stone Tudor arch. The second story is of timber and plaster construction. It has two large brick chimneys and ventilation dormers in the attic or third story. (photo #17)
29. The Colonial Manor Nursing Home (Leibee House) (508 South Main Street), built in 1872, is South Main's only example of the Italian Villa architectural style. Its square, off center, three story tower is topped with a balustrade or "Widow's Walk". It has eave brackets and a large veranda. Its second story windows are stilted segmental arches and its first story windows are round arches. All have hood molds. It has several hexagonal bay windows. (photo #18)
30. Carnahan House (510 South Main Street), Queen Anne, 1890's.
31. John Boyd House (512 South Main Street), Queen Anne, 1890's, has 3 tall brick chimneys at either side of house and veranda across front.



UNITED STATES DEPARTMENT OF THE INTERIOR  
NATIONAL PARK SERVICE

NATIONAL REGISTER OF HISTORIC PLACES  
INVENTORY -- NOMINATION FORM

SOUTH MAIN STREET, MIDDLETOWN

FOR NPS USE ONLY

RECEIVED

DATE ENTERED

CONTINUATION SHEET

ITEM NUMBER 7

PAGE 5

32. William Hanger Johnson (514 South Main Street), shingle/stick style, 1902.
33. 520 South Main Street, Queen Anne, 1890's, steep hip roof with slate shingles, 3 story turret, veranda with balustrade.
34. 600 South Main Street, Queen Anne, 1890's, round shingled tower. First story in ship-lap siding, second in fish scale siding. (photo #20)
35. D. E. Harlan House (604 South Main Street), shingle style, 1890's, several arched leaded windows, fish scale shingles. (photo #21)
36. 606 South Main Street, tudor, 1880's, partial brick first floor, plaster and half timber remainder of first and second.
37. 610 South Main Street, Queen Anne, 1890's tower on south side, large front gable, steeply pitched roof.
38. 614 South Main Street, Wrightian, 1910.
39. 700 South Main Street, Queen Anne, around 1910.
40. 704 South Main Street, shingle style large Queen Anne with 2 dormers in the front with leaded glass windows. Leaded stained glass windows on projecting side bays. Unpainted oak front door. Two large brick chimneys. (photo #23)
41. Harrison House (609 South Main Street), Queen Anne, 1900's.
42. 605 South Main Street, Queen Anne, 1900's.
43. 603 South Main Street, early 1900's.
44. 601 South Main Street, Queen Anne, 1890's.
45. 525 South Main Street, Colonial or Georgian revival 1880.
46. 521 South Main Street, non-descript early 1900's.

UNITED STATES DEPARTMENT OF THE INTERIOR  
NATIONAL PARK SERVICE

FOR NPS USE ONLY

RECEIVED

DATE ENTERED

NATIONAL REGISTER OF HISTORIC PLACES  
INVENTORY -- NOMINATION FORM

SOUTH MAIN STREET, MIDDLETOWN

CONTINUATION SHEET

ITEM NUMBER 7

PAGE 6

47. 517 South Main Street, non-descript early 1900's.
48. Dechant House (513 South Main Street), Queen Anne, 1890's, diamond shaped shingle roof, fish scale wood shingles, doric columns.
49. Renick House (509 South Main Street), altered beyond recognition, 1890's.
50. Stahl House (507 South Main Street), Georgian Revival, 1886.
51. Billman House (503 South Main Street), Queen Anne, 1891, rusticated stone lintels over brick construction, all original woodwork to original condition.
52. Breiel House (501 South Main Street), Queen Anne, 1886, several chimneys, shingle siding front porch with narrow columns.
53. Niederlander House (321 South Main Street), Queen Anne, 1890, Greek Doric columns front porch.
54. 317 South Main Street, Greek Revival influences, Greek Doric porch columns with entasis, pediment style roof on both house and porch.
55. 313 South Main Street, Queen Anne, 1890.
56. Sabin Robbins, Jr. House (309 South Main Street), Jacobethian Revival.
57. Sabin Robbins, Sr. House (305 South Main Street), Queen Anne, early 1900's. Two Palladin motif windows with stone lintels and arch, stained glass windows. (photo #27)
58. Thomas Woodward House (301 South Main Street), Jacobethian Revival, 1892. Two story turret, stone Tudor arched veranda.



UNITED STATES DEPARTMENT OF THE INTERIOR  
NATIONAL PARK SERVICE

FOR NPS USE ONLY

RECEIVED

DATE ENTERED

NATIONAL REGISTER OF HISTORIC PLACES  
INVENTORY -- NOMINATION FORM

SOUTH MAIN STREET, MIDDLETOWN

CONTINUATION SHEET

ITEM NUMBER 7

PAGE 7

59. Wampler Denny House (231 South Main Street), non-descript.
60. Judge Todhunter House (229 South Main Street), non-descript, 1890's.
61. 223 and 225 South Main Street, non-descript, 1893.
62. Winchester House (219 South Main Street), was built around 1878 by the Thomas family. It features a 3 story Italianate tower of the front of a Colonial style house. (photo #25)
63. 220 Yankee Road, Victorian.
64. 224 Yankee Road, Victorian influences.
65. The Jones House (228 Yankee Road), was built around 1890 transitional style, featuring an American Craftsman style wood porch and bracketed eaves. Intersecting gable roof. (photo #29)
66. The Hagen House (240-242 Yankee Road), built around 1890 in High Victorian Gothic in style with its steeply pitched front gable, pointed arched window and "gingerbread" wood carving on the front and side porches. (photo #31)
67. 201 S. Main Street, front part of house dates from 1847. This house has been scheduled for demolition as part of the improvement of Second Avenue.
68. 1006 Second Avenue, wood frame with gingerbread details.
69. 1011-1013 Second Avenue, non-descript.
70. 1007-1009 Second Avenue, non-descript.
71. 129 South Main Street, circa 1920.
72. The American Red Cross, Middletown Chapter (125 South Main Street), was built in 1894, by George Shafor in the Queen Anne style with classical influences.



UNITED STATES DEPARTMENT OF THE INTERIOR  
NATIONAL PARK SERVICE

**NATIONAL REGISTER OF HISTORIC PLACES  
INVENTORY -- NOMINATION FORM**

FOR NPS USE ONLY

RECEIVED

DATE ENTERED

SOUTH MAIN STREET, MIDDLETOWN

CONTINUATION SHEET

ITEM NUMBER 7

PAGE 8

73. The Simon Goldman Residence (121 South Main Street), was built in 1891 in Queen Anne style. The first story is of rusticated limestone with wood. Extensive handcarved interior woodwork. (photo # 33)
74. Middletown Baptist Temple (119 South Main Street), late gothic revival, circa 1905.
75. The Thompson House (115 South Main Street), built in 1867, is of Carpenter Gothic style. It has intricate wood carving on the porch supports and eaves as well as scalloped barge boards. The roof pitches are all very steep and windows are tall emphasizing verticality. There is a small pointed arched ventilation opening in the front gable. (photo # 34)
76. 109 South Main Street, Greek Revival, circa 1870.
77. Sol Finkelman Real Estate (107 South Main Street), High Victorian Italianate, 1880's.
78. 1002 First Avenue/103 South Main Street. Built before 1860 in Georgian Revival style and has since been altered several times.
79. 1008 First Avenue, non-descript.
80. Sears Auto Center (71 South Main Street), contemporary intrusion. (photo # 35)
81. The Sorg Opera House (53-67 South Main Street), now known as the Colonia Theatre or Commercial Building, was built in 1890. The facade is of Richardsonian Romanesque style with red and white limestone used. The remainder of the building is brick. The fourth story windows are red limestone arches with red and white limestone pattern above. There is a red limestone balcony off the third story central windows. The remainder of the building is white limestone with red courses between the stories. The first floor facade has been altered. (photo # 36)



## 8 SIGNIFICANCE

### PERIOD

### AREAS OF SIGNIFICANCE -- CHECK AND JUSTIFY BELOW

<input type="checkbox"/> PREHISTORIC	<input type="checkbox"/> ARCHEOLOGY-PREHISTORIC	<input type="checkbox"/> COMMUNITY PLANNING	<input type="checkbox"/> LANDSCAPE ARCHITECTURE	<input type="checkbox"/> RELIGION
<input type="checkbox"/> 1400-1499	<input type="checkbox"/> ARCHEOLOGY-HISTORIC	<input type="checkbox"/> CONSERVATION	<input type="checkbox"/> LAW	<input type="checkbox"/> SCIENCE
<input type="checkbox"/> 1500-1599	<input type="checkbox"/> AGRICULTURE	<input type="checkbox"/> ECONOMICS	<input type="checkbox"/> LITERATURE	<input type="checkbox"/> SCULPTURE
<input type="checkbox"/> 1600-1699	<input checked="" type="checkbox"/> ARCHITECTURE	<input type="checkbox"/> EDUCATION	<input type="checkbox"/> MILITARY	<input type="checkbox"/> SOCIAL/HUMANITARIAN
<input type="checkbox"/> 1700-1799	<input type="checkbox"/> ART	<input type="checkbox"/> ENGINEERING	<input type="checkbox"/> MUSIC	<input type="checkbox"/> THEATER
<input checked="" type="checkbox"/> 1800-1899	<input type="checkbox"/> COMMERCE	<input type="checkbox"/> EXPLORATION/SETTLEMENT	<input type="checkbox"/> PHILOSOPHY	<input type="checkbox"/> TRANSPORTATION
<input checked="" type="checkbox"/> 1900-	<input type="checkbox"/> COMMUNICATIONS	<input checked="" type="checkbox"/> INDUSTRY	<input type="checkbox"/> POLITICS/GOVERNMENT	<input type="checkbox"/> OTHER (SPECIFY)
		<input checked="" type="checkbox"/> INVENTION		

### SPECIFIC DATES

### BUILDER/ARCHITECT

### STATEMENT OF SIGNIFICANCE

In 1802 Stephen Vail and his son Shobal Vail from New Jersey, obtained patents from the United States government for parts of Section 29, Lemon Township, Butler County, Ohio. The first plat of Middletown contained 52 lots with Main Street the central point. The first block of the South Main Street Historic Area has then always been the heart of Middletown.

The oldest residence in the historical area (27) was built in 1827, the newest (next door at 26) was built 100 years later in 1927. Architecturally they represent a century of style; historically they represent over a century of growth because they have housed men of significance in local history. The largest value of the South Main area is its intact representation of late 19th century and early 20th century architectural styles including Victorian, Romanesque, Queen Anne, Shingle style, Greek revival, Tudor, Carpenter's Gothic, and their variations.

As the commercial part of the town extended eastward out Central Avenue, the prospering leaders of industry built homes to the south on Main Street. The historic area still presents the same atmosphere that it always had: beautiful, stately homes on a tree-lined street. A few of the ornate iron fences (77, 15, 53), circular drives (27), granite curbs, yard liners and steps still survive. South Main Street still has turrets and towers (15, 37, 62, 73), a belvedere (29), crystal chandeliers, beautiful hand-carved staircases (51, 62, 72, 73), a window attributed to Tiffany (21), Rookwood bathrooms (26, 52), a Rookwood fireplace (26) and gargoyles and two griffens (15, and from 20 now at adjacent Forest Hills Club).

As the years went on the leaders of industry bought lots on South Main and built new houses or bought the old houses and enlarged them. The men who lived on Main Street created the history of Middletown; they were innovators and their innovations spread through the United States and the world.



UNITED STATES DEPARTMENT OF THE INTERIOR  
NATIONAL PARK SERVICE

FOR NPS USE ONLY

RECEIVED

DATE ENTERED

**NATIONAL REGISTER OF HISTORIC PLACES  
INVENTORY -- NOMINATION FORM**

SOUTH MAIN STREET, MIDDLETOWN

CONTINUATION SHEET

ITEM NUMBER 8 PAGE 2

One of South Main Street and Middletown's most famous residents was Paul J. Sorg, a prolific innovator. In 1870, when he was 30, he came to Middletown to establish the P. J. Sorg Tobacco Company, shortly to become one of the world's largest concerns of its kind. He was Middletown's first millionaire. P. J. Sorg was active in tobacco, pumps, farm machinery, bicycles, naval equipment, gas and paper. He brought the Pennsylvania Railroad to Middletown; he served twice as a member of the U.S. Congress (1892). He bought and refurbished the U. S. Hotel (1) making it a fine meeting place for society; he built the Sorg Opera House (81) in 1890 to bring culture to Middletonians; he and his wife gave impetus to the building of the First Baptist Church (74) by donating money and the glass windows.

To modern day Middletonians Sorg's most amazing contribution to Middletown was his home, the Sorg Mansion (15). This Romanesque "castle" was built in 1887. In 1902 a \$100,000 addition comprised a north wing with a ballroom, a front porch and turrets, a large carriage house and an imposing stone and iron fence around the 5 acre property. Sorg put in a private electric lighting system supplying electricity to his home, the U. S. Hotel, the Sorg Opera House and other Sorg buildings.

George Verity (20) started the American Rolling Mill Company (now called Armco Steel Corporation) in 1902. While working as the manager of a roofing plant in Kentucky, he had trouble with his material suppliers. He thought that everything could be manufactured in one plant under one roof. He applied this idea to his new steel mill; pig iron and scrap iron were converted into manufactured building materials ready for the consumer's use under one continuous plant on one plot of ground. This innovation in the business was quickly copied over the United States. Armco was to bring prosperity and other industries to Middletown.

At this point in time, J. P. Morgan and Andrew Carnegie were gobbling up steel mills to form huge corporations. George Verity knew that to stay in business his steel mill would have to be different. He went out of his way to treat his workers as humans and as friends and made a point to listen to their ideas. This attracted inventive men from other larger mills; the first research division in a steel mill evolved. (Many of these outstanding men were to live on South Main Street.)



UNITED STATES DEPARTMENT OF THE INTERIOR  
NATIONAL PARK SERVICE

**NATIONAL REGISTER OF HISTORIC PLACES  
INVENTORY -- NOMINATION FORM**

FOR NPS USE ONLY

RECEIVED

DATE ENTERED

SOUTH MAIN STREET, MIDDLETOWN

CONTINUATION SHEET

ITEM NUMBER 8

PAGE 3

John B. Tytus (21) grew up in Middletown, working in his father's paper mill. When he started to work for the American Rolling Mills, he thought that the method of rolling paper could be applied to metal. In 1927, after 3 years of trial, sheet steel passed smoothly through numerous rolls in a continuous rolling process to emerge the desired thickness and width. Armco allowed other major steel companies to use Tytus' invention under licensing grants and economical sheet steel revolutionized the automobile and appliance industries.

Sabin Robbins, Sr. (57), president of the Sabin Robbins Paper Company, then in Middletown and now in Cincinnati, also was an innovator. When a competitor offered him two carloads of cardboard at a bargain, he bought them, cut the cardboard into oblong shapes and sold the pieces to laundries thus creating the first shirtboards. He was also the person who first gilded the edges of playing cards.

J. K. Thomas (62) was instrumental in the founding of Wooster College, Wooster, Ohio.

Paper mills have flourished in Middletown, each specializing in different types of paper and cardboard. Alexander Hill's (16) mill made the first manilla paper west of the Alleghenys.

Middletown street names and park names reflect the names of South Main Street residents - Leibe Street, Lefferson Road, Verity Parkway, Tytus Avenue, Goldman Park, Todhunter Road, Lefferson Park, Barnitz Park, and Breiel Boulevard.

It should be noted that the east bound State Route #122 (Second Avenue) is planned for improvement. The effects on the historical area will be beneficial since this change will provide the rerouting of heavier traffic off of South Main Street. The improvement of this street has been part of the City's Master Plan since 1963. It may effect the following properties: Sohio (#13), 909-911 Second Avenue (#14), 201 S. Main Street (#67), 1006 Second Avenue (#68).

First Avenue is also scheduled for improvement. The widening activity has been designed to begin on the north side of the street affecting the intrusion at 71 South Main Street (Sears Auto Center, #80).



## 9 MAJOR BIBLIOGRAPHICAL REFERENCES

See attached Section #9

## 10 GEOGRAPHICAL DATA

ACREAGE OF NOMINATED PROPERTY 40.5

UTM REFERENCES

A 16 723160 43771070  
ZONE EASTING NORTHING  
C 16 722340 4376130

B 16 722560 4376130  
ZONE EASTING NORTHING  
D 16 722920 4377190

VERBAL BOUNDARY DESCRIPTION

See attached Section #10

LIST ALL STATES AND COUNTIES FOR PROPERTIES OVERLAPPING STATE OR COUNTY BOUNDARIES

STATE	CODE	COUNTY	CODE
STATE	CODE	COUNTY	CODE

## 11 FORM PREPARED BY

NAME/TITLE David A. Clark  
Department of Planning & Community Development  
ORGANIZATION City of Middletown DATE March 10, 1977  
STREET & NUMBER One Civic Center Plaza TELEPHONE 513-425-7766  
CITY OR TOWN Middletown STATE Ohio

## 12 STATE HISTORIC PRESERVATION OFFICER CERTIFICATION

THE EVALUATED SIGNIFICANCE OF THIS PROPERTY WITHIN THE STATE IS:

NATIONAL ☐

STATE ☒

LOCAL ☐

As the designated State Historic Preservation Officer for the National Historic Preservation Act of 1966 (Public Law 89-665), I hereby nominate this property for inclusion in the National Register and certify that it has been evaluated according to the criteria and procedures set forth by the National Park Service.

STATE HISTORIC PRESERVATION OFFICER SIGNATURE 

TITLE State Historic Preservation Officer

DATE 9/21/76

FOR NPS USE ONLY

I HEREBY CERTIFY THAT THIS PROPERTY IS INCLUDED IN THE NATIONAL REGISTER

DATE

DIRECTOR, OFFICE OF ARCHEOLOGY AND HISTORIC PRESERVATION

ATTEST:

DATE

KEEPER OF THE NATIONAL REGISTER



UNITED STATES DEPARTMENT OF THE INTERIOR  
NATIONAL PARK SERVICE

NATIONAL REGISTER OF HISTORIC PLACES  
INVENTORY -- NOMINATION FORM

FOR NPS USE ONLY

RECEIVED

DATE ENTERED

SOUTH MAIN STREET, MIDDLETOWN

CONTINUATION SHEET

ITEM NUMBER 9 PAGE 1

Borth, Christy, True Steel, Story of George Verity and Associates.  
New York, Bobbs-Merrill Company

Becker, Earl M., "John Butler Tytus", Dictionary of American  
Biography, Supplement Three. New York, 1973, p. 779, 782.

Crout, George, Middletown, U.S.A., All-American City.  
Middletown, Ohio, Perry Printing Company, 1960.

Crout, George, "Middletown Diary" Middletown Journal (weekly columns)

History of Butler County, Ohio, 1882, Butler County Historical  
Society, p. 631

Oglesby, Robert, Portrait of William B. Oglesby. Privately published.

Robbins, Mrs. Douglas (Pauline), "Middletown Attic Treasurers",  
paper for Current Events Club, April 5, 1976.

Simms, Harry, Middletown in Black and White.  
Middletown, Ohio, The Journal Printing Company.

Interviews:

Bensing, Mrs. Easter, Butler County Archivist, Butler County  
Courthouse, Hamilton, Ohio.

Crout, George, Middletown Historian

Lindeman, Joseph, life-long South Main Street resident in  
his grandfather Simon Goldman's home.

Thompson, Dr. V. C. and Winifred, South Main Street residents.

Verity, Calvin and Elizabeth; Calvin Verity has lived in 5 different  
houses on South Main Street since 1900.

Vorhis, Wilfred, Middletown Historian, Main Street resident in 1898.

Wilson, Mrs. Thomas (Elizabeth), Sr., officer in the Wilson Funeral  
Home (now Wilson-Schramm) which served over 100 years on South  
Main in two locations, 64 and 210.



UNITED STATES DEPARTMENT OF THE INTERIOR  
NATIONAL PARK SERVICE

FOR NPS USE ONLY

RECEIVED

DATE ENTERED

**NATIONAL REGISTER OF HISTORIC PLACES  
INVENTORY -- NOMINATION FORM**

SOUTH MAIN STREET, MIDDLETOWN

CONTINUATION SHEET

ITEM NUMBER 10 PAGE 1

Section 10, Verbal Description

The South Main Street Historic Area in the City of Middletown, Butler County, Ohio, basically includes those properties fronting South Main Street between and including #34 and #704 (1-40) South Main on the western side and #53 and #609 (39-60, 67-76) South Main on the eastern side. It also includes the first four properties fronting Yankee Road on the western side (220, 224, 228, 240 Yankee Road; 61-64) and two properties fronting Second Avenue (1007, 1011 Second Avenue - 65, 66). The area is more specifically described as follows:

Beginning at a point at the northeast corner of the intersection of South Main Street and Yankee Road; thence southward along the eastern right-of-way of Yankee Road to a point at the intersection of the extended southern lot line of Lot #1076; thence westward along the extended southern lot line of Lot #1076 to a point along the eastern lot line of Lot #1090; thence southward along the eastern (rear) lot lines of Lots #1090, 1089, 1088; thence westward along the southern lot line of Lot #1088 to the intersection of the rear (eastern) property lines of #317 (Pt. Lot 1086) and #321 (Pt. Lot 1085) South Main Street thence southward along said property line extended to the southern right-of-way of Fourth Avenue; thence westward along the southern right-of-way of Fourth Avenue to the eastern right-of-way of South Main Street; thence southward along the eastern right-of-way of South Main Street to the northern right-of-way of Fifth Avenue; thence eastward along the northern right-of-way of Fifth Avenue to the intersection of the extended western right-of-way of an alley east of and parallel to South Main Street; thence southward along the western right-of-way, crossing Sixth Avenue, to the intersection of the extended southern lot line of Lot #819; thence westward along the southern lot line of Lot #819 to the eastern right-of-way of South Main Street; thence southward along the eastern right-of-way of South Main Street to the intersection of the extended southern lot line of Lot #6172; thence westward along the extended southern lot line of Lot #6172 to the eastern right-of-way of an alley west of and parallel to South Main Street; thence northward along the eastern right-of-way of the alley, crossing Seventh Avenue, to the northern right-of-way of Sixth Avenue; thence westward along the northern right-of-way of Sixth Avenue to the intersection of the western (rear) property line of 514 South Main Street; thence northward along the rear property lines of



UNITED STATES DEPARTMENT OF THE INTERIOR  
NATIONAL PARK SERVICE

**NATIONAL REGISTER OF HISTORIC PLACES  
INVENTORY -- NOMINATION FORM**

FOR NPS USE ONLY

RECEIVED

DATE ENTERED

SOUTH MAIN STREET, MIDDLETOWN

CONTINUATION SHEET

ITEM NUMBER 10 PAGE 2

512, 510, 508, 502, 404, 400 South Main Street to the southern right-of-way of Fourth Avenue; thence eastward along the southern right-of-way of Fourth Avenue to the intersection of the extended western (rear) property line of 320 South Main Street; thence northward along the rear property lines of 320, 314, 308, 306, 300, and extending in a straight line northward to the southern property line of 218 South Main Street; thence westward and northward following the rear property lines of #218, 214, 210, 206 South Main Street to the southern right-of-way of Second Avenue; thence eastward along the southern right-of-way of Second Avenue to the extended eastern right-of-way of an alley west of and parallel to South Main Street; thence northward along the eastern right-of-way of the alley crossing First Avenue, the northern property line of #34 South Main Street; thence eastward along the northern property line of #34 South Main Street, to the eastern right-of-way of South Main Street; thence southward along the eastern right-of-way to the northern lot line of Lot #19; thence eastward along the northern lot line of Lot #19 extended to the western right-of-way of Wall Alley; thence southward along the western right-of-way of Wall Alley to the northern right-of-way of First Avenue to the extended eastern property line of #1012 First Avenue, thence southward to the northern property line of #107 South Main Street; and eastward along the northern property line of #107 South Main Street to the westerly right-of-way of Wall Alley; thence southward along the western right-of-way of Wall Alley to the northern right-of-way of Second Avenue; thence westward along the northern right-of-way of Second Avenue to the extended eastern property line of #1006 Second Avenue. Thence southward, westward, and northward along the property lines of 1006 Second Avenue to the southern property line of #201 South Main Street; thence westward along the southern property line of #201 South Main Street to the eastern right-of-way of South Main Street; thence southward along the eastern right-of-way of South Main Street to the point of beginning.

k2/1



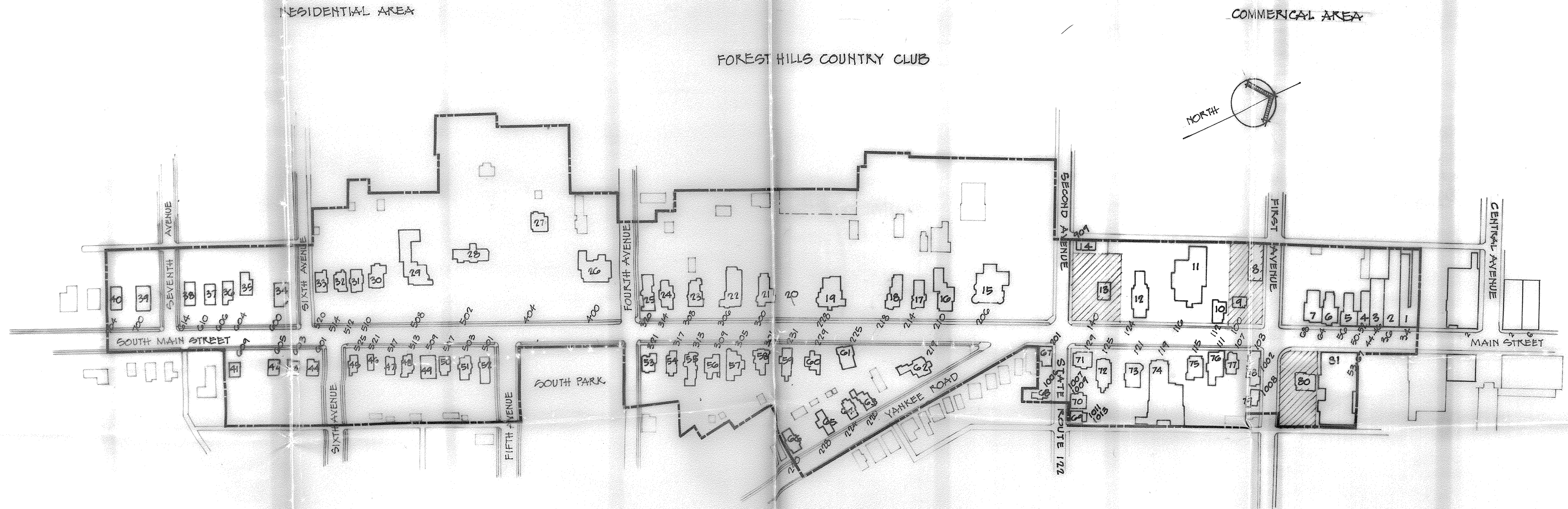

SOUTH MAIN STREET  
MIDDLETOWN, OHIO BUTLER COUNTY  
Scale 1" = 200'

MIXED RESIDENTIAL and COMMERCIAL DISTRICT

----- DISTRICT BOUNDARY

▨ INTRUSION AREA

NOTE • SEE ITEM #1 FOR ARCHITECTURE STYLE

ACREAGE = 40.5 acres

PREPARED BY •

THE DEPARTMENT OF PLANNING AND COMMUNITY DEVELOPMENT

ONE CIVIC CENTRE PLAZA

7-19-77

MIDDLETOWN, OHIO 45042

JW HOWARD